



# SC-10AH / SC-15AH / SC-30AH

100 V Horn Speakers



## Features

- 10W - 15W - 30W
- 100V
- 103 - 105 - 107 dB SPL
- ABS
- IP66

SC-10, SC-15 and SC-30 are high quality square type Horn Speakers providing performance even in the harshest environments. Straight and ultra-high power horns give a highly articulate sound performance in high noise areas or at large gatherings of people.

All models include a line transformer for 100V constant voltage operation. A tap switch is available at the back of the speaker to change the impedance for different power applications.

The bracket is "U" shaped and makes easy the mounting on any support for multi-directional coverages. Made of ABS resin, the devices are IP66 and can be used any places indoor or outdoor.

## Specifications

MODEL	SC-10AH	SC-15AH	SC-30AH
Type	Reflex - Square	Reflex - Square	Reflex - Square
Rated Input Power	10W	15W	30W
Transformer Tap	1, 3, 5, 10W	1, 3, 5, 10, 15W	1, 3, 5, 10, 15, 30W
Input Impedance (100V)	1k, 2k, 3.3k, 10k Ohms	0.67k, 1k, 2k, 3.3k, 10k Ohms	0.33k, 0.67k, 1k, 2k, 3.3k, 10k Ohms
Preset Impedance (100V)	1k Ohms	670 Ohms	330 Ohms
Input Impedance (70/25V)	63, 130 Ohms (25V only)	42, 63, 170 Ohms (25V only)	21, 42, 63 Ohms (25V only)
Preset Impedance (70/25V)	0.5, 1k, 1.7k, 2.9k Ohms	0.33k, 0.5k, 1k, 1.3k, 2.3k Ohms	0.17k, 0.33k, 0.5k, 1k, 1.3k, 2.3k Ohms
Frequency Response	500 Hz ~ 6 kHz	450 Hz ~ 5 kHz	350 Hz ~ 5 kHz
SPL (1W/1m)	103 dB	105 dB	107 dB
Coverage (at 1kHz, H x V)	60° x 60°	70° x 70°	90° x 60°
Material	ABS	ABS	ABS
Protection Rate	IP66	IP66	IP66
Bracket	"U" shaped	"U" shaped	"U" shaped
Pantone	Ivory 1205C	Ivory 1205C	Ivory 1205C
Weight	1.37 kg	1.58 kg	1.98 kg

Specifications subject to modification without notice

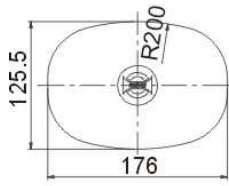

SC-10AH

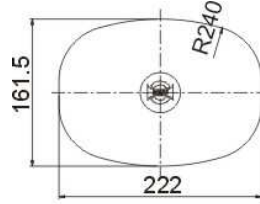
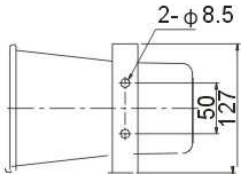
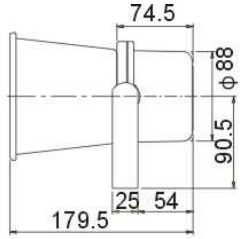

SC-15AH

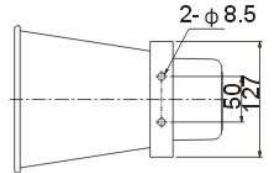
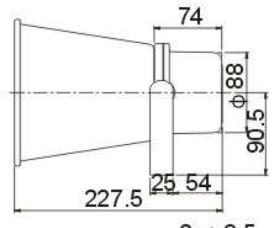

SC-30AH

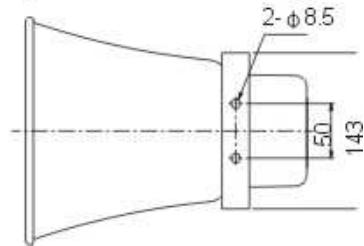
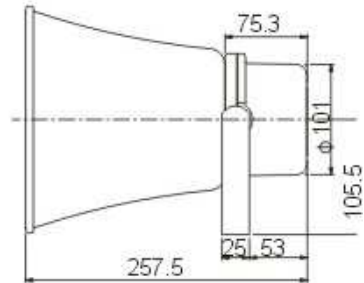

“U” Shaped Mounting Bracket

